

Specifications R210W-9A

ENGINE

MODEL	CUMMINS QSB6.7	
Type	Water cooled, 4 cycle Diesel, 6-cylinders in line, direct injection, turbocharged, charged air cooled and low emission	
Rated flywheel horse power		
SAE	J1995 (gross)	173 HP (129 kW) / 2,000 rpm
	J1349 (net)	163 HP (121 kW) / 2,000 rpm
DIN	6271/1 (gross)	175 PS (129 kW) / 2,000 rpm
	6271/1 (net)	165 PS (121 kW) / 2,000 rpm
Max. torque	81.7 kgf.m (591 lbf.ft) / 1,500 rpm	
Bore x stroke	107 x 124 mm (4.2" x 4.9")	
Piston displacement	6,700 cc (409 in ³)	
Batteries	2 x 12 V x 100 Ah	
Starting motor	24 V - 4.8 kW	
Alternator	24 V - 95 A	

* This engine meets the EPA (Tier 4 interim) / EU (Stage III-B) Emission regulation.

HYDRAULIC SYSTEM

MAIN PUMP	
Type	Two variable displacement piston pumps
Max. flow	2 x 228 l/min
Sub-pump for pilot circuit	Gear pump

Cross-sensing and fuel saving pump system

HYDRAULIC MOTORS	
Travel	Variable displacement piston motor with brake valve
Swing	Axial piston motor with automatic brake

RELIEF VALVE SETTING	
Implement circuits	350 kgf/cm ² (4,980 psi)
Travel	380 kgf/cm ² (5,400 psi)
Power boost (boom, arm, bucket)	380 kgf/cm ² (5,400 psi)
Swing circuit	265 kgf/cm ² (3,770 psi)
Pilot circuit	40 kgf/cm ² (570 psi)
Service valve	Installed

HYDRAULIC CYLINDERS	
No. of cylinder-bore x stroke	Boom : 2-120 x 1,290 mm (4.7" x 50.8")
	Arm : 1-140 x 1,510 mm (5.5" x 59.4")
	Bucket : 1-125 x 1,055 mm (4.9" x 41.5")
	Blade : 2-120 x 226 mm (4.7" x 8.9")
	Outrigger : 2-130 x 427 mm (5.1" x 16.8")

DRIVES & BRAKES

4-wheel hydrostatic drive. Constant mesh, helical gear transmission provides 2 forward and reverse travel speeds.

Max. drawbar pull	11,900 kgf (26,240 lbf)	
Travel speed	1st	9.2 km/h (5.7 mph)
	2nd	35 km/h (21.7 mph)
Gradeability	31.5° (61 %)	

Parking brake : Independent dual brake, front and rear axle full hydraulic power brake.

- Spring activated and hydraulic released
- Wet type multiple disk brake

CONTROL

Pilot pressure operated joysticks and pedals with detachable lever provide almost effortless and fatigueless operation.

Pilot control	Two joysticks with one safety lever (LH): Swing and arm (RH): Boom and bucket (ISO)
Engine throttle	Electric, Dial type

AXLE & WHEEL

Free oscillation front axle which can be blocked automatically or manually. Fixed rear axle for max. stability.

Tires	10.00 - 20 - 16PR, Dual (tube type)
(optional)	10.00 - 20, Dual (solid type)

SWING SYSTEM

Swing motor	Fixed displacement axial piston motor
Swing reduction	Planetary gear reduction
Swing bearing lubrication	Grease-bathed
Swing brake	Multi wet disc
Swing speed	9.7 rpm

STEERING SYSTEM

Hydraulically actuated, orbitrol type steering system.

Min. turning radius	6.69 m (21'11")
---------------------	-----------------

COOLANT & LUBRICANT CAPACITY

	liter	US gal	UK gal
Fuel tank	310.0	81.9	68.2
Engine coolant	35.0	9.2	7.7
Engine oil	23.1	6.1	5.1
Swing device - gear oil	5	1.3	1.1
Axle	Front	14.6	3.9
	Rear	18.5	4.9
Hydraulic system (including tank)	340.0	89.8	74.8
Hydraulic tank	165.0	43.6	36.3

UNDERCARRIAGE

Reinforced box-section frame is all-welded, low-stress.

Dozer blade and outriggers are available. A bolt-on design.

Dozer blade	A very useful tool for leveling, back filling or clean-up work.
Outrigger	Maximum stability for digging and lifting work, can be installed on the front and/or rear side.

OPERATING WEIGHT (APPROXIMATE)

Operating weight, including 5,650 mm (18'6") One-piece boom, 2,920 mm (9'7") arm, SAE heaped 0.80 m³ (1.05 yd³) backhoe bucket, lubricant, coolant, full fuel tank, full hydraulic tank and all standard equipments.

MAJOR COMPONENT WEIGHT	
Upperstructure	5,240 kg (11,550 lb)
Mono boom (with arm cylinder)	1,790 kg (3,950 lb)

OPERATING WEIGHT	
Front outriggers and rear blade	20,500 kg (45,200 lb)
Front blade and rear outriggers	20,500 kg (45,200 lb)
Front and rear outriggers	20,600 kg (45,400 lb)

BUCKETS R210W-9A

All buckets are welded with high-strength steel.



0.51 (0.67)

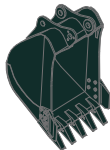

0.80 (1.05)
0.87 (1.14)
0.92 (1.20)

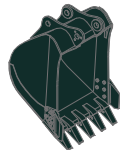

1.10 (1.44)
1.20 (1.57)

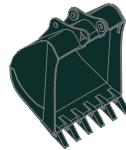

1.34 (1.75)



◆ 0.74 (0.97)
0.90 (1.18)
1.05 (1.37)



⊙ 0.87 (1.14)

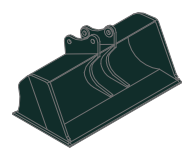

▣ 0.75 (0.98)

SAE heaped m³ (yd³)

Capacity m ³ (yd ³)		Width mm (in)		Weight kg (lb)	Recommendation m (ft.in)		
SAE heaped	CECE heaped	Without side cutters	With side cutters		5.65 (18' 6") Boom		
					2.0 (6' 7") Arm	2.4 (7' 10") Arm	2.92 (9' 7") Arm
0.51 (0.67)	0.45 (0.59)	700 (27.6)	820 (32.3)	570 (1,260)	●	●	●
0.80 (1.05)	0.70 (0.92)	1,000 (39.4)	1,120 (44.1)	700 (1,540)	●	●	●
0.87 (1.14)	0.75 (0.98)	1,090 (42.9)	1,210 (47.6)	740 (1,630)	●	●	●
0.92 (1.20)	0.80 (1.05)	1,150 (45.3)	1,270 (50.0)	770 (1,700)	●	●	■
1.10 (1.44)	0.96 (1.26)	1,320 (52.0)	1,440 (56.7)	830 (1,830)	●	■	▲
1.20 (1.57)	1.00 (1.31)	1,400 (55.1)	1,520 (59.8)	850 (1,870)	●	■	—
1.34 (1.75)	1.15 (1.50)	1,550 (61.0)	1,670 (65.7)	920 (2,030)	■	▲	—
◆ 0.74 (0.97)	0.65 (0.85)	985 (38.8)	-	770 (1,700)	●	●	●
◆ 0.90 (1.18)	0.80 (1.05)	1,095 (43.1)	-	810 (1,790)	●	●	■
◆ 1.05 (1.37)	0.92 (1.20)	1,290 (50.8)	-	890 (1,960)	●	■	▲
⊙ 0.87 (1.14)	0.75 (0.98)	1,140 (44.9)	-	900 (1,980)	●	●	■
▣ 0.75 (0.98)	0.65 (0.85)	1,790 (70.5)	-	880 (1,940)	●	●	■

◆ Heavy-duty bucket

⊙ Heavy duty rock-bucket

▣ Slope finishing bucket

● : Applicable for materials with density of 2,000 kg/m³ (3,370 lb/yd³) or less

■ : Applicable for materials with density of 1,600 kg/m³ (2,700 lb/yd³) or less

▲ : Applicable for materials with density of 1,100 kg/m³ (1,850 lb/yd³) or less

ATTACHMENT R210W-9A

Booms and arms are welded, a low-stress, full-box section design.

5.65 m (18' 6") boom and 2.0 m (6' 7"); 2.4 m (7' 10") & 2.92 m (9' 7") arms are available.

DIGGING FORCE R210W-9A

Arm	Length	mm (ft-in)	2,000 (6' 7")	2,400 (7' 10")	2,920 (9' 7")	Remarks:
	Weight	kg (lb)	975 (2,150)	1,045 (2,300)	1,095 (2,410)	
Bucket digging force	SAE	kN	133.4 [144.8]	133.4 [144.8]	133.4 [144.8]	[]: Power Boost
		kgf	13600 [14770]	13600 [14770]	13600 [14770]	
		lbf	29980 [32550]	29980 [32550]	29980 [32550]	
	ISO	kN	152.0 [165.0]	152.0 [165.0]	152.0 [165.0]	
		kgf	15500 [16830]	15500 [16830]	15500 [16830]	
		lbf	34170 [37100]	34170 [37100]	34170 [37100]	
Arm crowd force	SAE	kN	144.2 [156.5]	119.6 [129.9]	102.0 [110.7]	
		kgf	14700 [15960]	12200 [13250]	10400 [11290]	
		lbf	32410 [35190]	26900 [29210]	22930 [24900]	
	ISO	kN	151.0 [164.0]	125.5 [136.3]	106.9 [116.1]	
		kgf	15400 [16720]	12800 [13900]	10900 [11830]	
		lbf	33950 [36860]	28220 [30640]	24030 [26090]	

Note: Arm weight includes bucket cylinder, linkage and pin

Dimensions & Working Ranges

DIMENSIONS R210W-9A

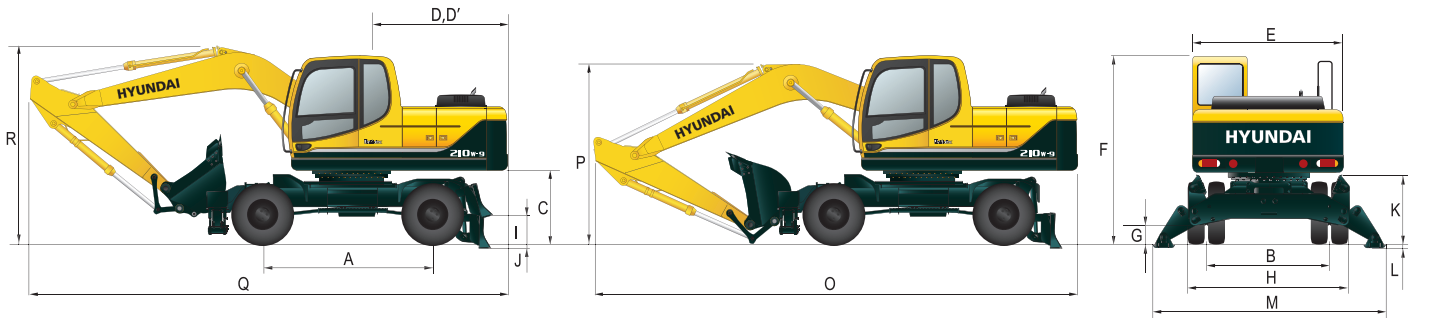

	mm (ft · in)
A Wheel base	2,800 (9' 2")
B Tread	1,914 (6' 3")
C Ground clearance of counterweight	1,305 (4' 3")
D Tail swing radius	2,800 (9' 2")
D' Rear-end length	2,765 (9' 1")
E Overall width of upperstructure	2,530 (8' 4")
F Overall height of cap	3,180 (10' 5")
G Min. ground clearance	345 (1' 2")
H Overall width of lower structure	2,495 (8' 2")
I Ground clearance of blade up	445 (1' 6")
Depth of blade down	120 (0' 5")
J Height of blade	610 (2' 0")
Width of blade	2,490 (8' 2")
K Ground clearance of outrigger up	1,220 (4' 0")
L Depth of outrigger down	120 (0' 5")
M Overall width of outrigger	3,770 (12' 4")

	mm (ft · in)		
Boom length	5,650 (18' 6")		
Arm length	2,000 (6' 7")	2,400 (7' 10")	2,920 (9' 7")
O Overall length shipping position	9,680 (31' 9")	9,570 (31' 5")	9,500 (31' 2")
P Height of attachment shipping position	3,350 (10' 12")	3,240 (10' 8")	3,150 (10' 4")
Q Overall length traveling position	9,630 (31' 7")	9,550 (31' 4")	9,520 (31' 3")
R Height of attachment traveling position	3,530 (11' 7")	3,460 (11' 4")	3,440 (11' 3")

WORKING RANGES R210W-9A

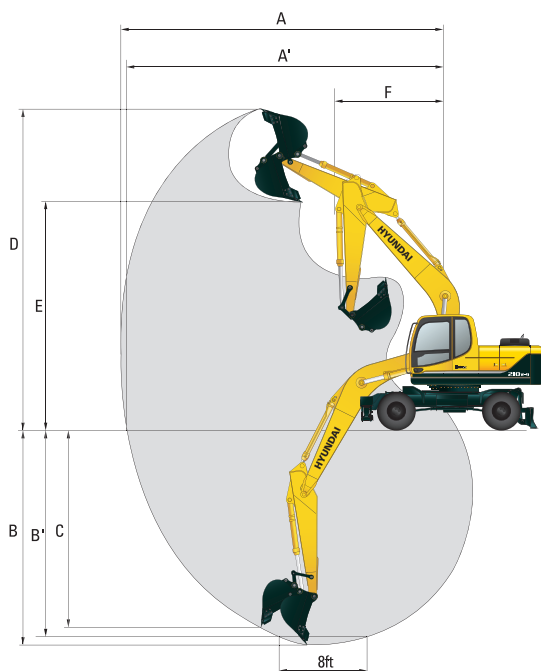

	mm (ft · in)		
Boom length	5,650 (18' 6")		
Arm length	2,000 (6' 7")	2,400 (7' 10")	2,920 (9' 7")
A Max. digging reach	9,110 (29' 11")	9,480 (31' 1")	9,960 (32' 8")
A' Max. digging reach on ground	8,870 (29' 1")	9,260 (30' 5")	9,750 (32' 0")
B Max. digging depth	5,480 (18' 0")	5,880 (19' 3")	6,380 (20' 11")
B' Max. digging depth (8' level)	5,240 (17' 2")	5,670 (18' 7")	6,210 (20' 4")
C Max. vertical wall digging depth	4,970 (16' 4")	5,470 (17' 11")	5,990 (19' 8")
D Max. digging height	9,500 (31' 2")	9,730 (31' 11")	10,000 (32' 10")
E Max. dumping height	6,670 (21' 11")	6,900 (22' 8")	7,160 (23' 6")
F Min. front swing radius	3,700 (12' 2")	3,620 (11' 11")	3,580 (11' 9")

Lifting Capacities

R210W-9A

Rating over-front Rating over-side or 360 degrees

Boom : 5.65 m (18' 6") / Arm : 2.40 m (7' 10") / Bucket : 0.80 m³ (1.05 yd³) SAE heaped / Front outrigger and rear dozer blade down

Load point height m (ft)		Load radius										At max. reach			
		1.5 m (5 ft)		3.0 m (10 ft)		4.5 m (15 ft)		6.0 m (20 ft)		7.5 m (25 ft)		Capacity		Reach	
														m (ft)	
7.5 m (25 ft)	kg lb												*3810	3690	7.34 (24.1)
6.0 m (20 ft)	kg lb						*4150 *9150	*4150 *9150					*3910 *8620	2890 6370	8.31 (27.3)
4.5 m (15 ft)	kg lb					*5500 *12130	*5500 *12130	*4710 *10380	*4710 *10380	*4390 *9680	3350 7390		*4050 *8930	2500 5510	8.87 (29.1)
3.0 m (10 ft)	kg lb					*7330 *16160	*7330 *16160	*5550 *12240	4700 10360	*4760 *10490	3230 7120		*4230 *9330	2320 5110	9.10 (29.9)
1.5 m (5 ft)	kg lb					*8950 *19730	6970 15370	*6390 *14090	4450 9810	*5180 *11420	3110 6860		*4430 *9770	2300 5070	9.05 (29.7)
Ground Line	kg lb			*9840 *21690	*9840 *21690	*9780 *21560	6720 14820	*6980 *15390	4290 9460	*5480 *12080	3030 6680		*4640 *10230	2440 5380	8.70 (28.5)
-1.5 m (-5 ft)	kg lb	*10680 *23550	*10680 *23550	*14730 *32470	14050 30970	*9850 *21720	6680 14730	*7130 *15720	4230 9330				*4830 *10650	2820 6220	8.00 (26.2)
-3.0 m (-10 ft)	kg lb	*15190 *33490	*15190 *33490	*13270 *29260	*13270 *29260	*9140 *20150	6780 14950	*6600 *14550	4300 9480				*4870 *10740	3730 8220	6.84 (22.4)
-4.5 m (-15 ft)	kg lb			*10270 *22640	*10270 *22640	*7070 *15590	*7070 *15590								

Boom : 5.65 m (18' 6") / Arm : 2.40 m (7' 10") / Bucket : 0.80 m³ (1.05 yd³) SAE heaped / Front outrigger and rear dozer blade up

Load point height m (ft)		Load radius										At max. reach			
		1.5 m (5 ft)		3.0 m (10 ft)		4.5 m (15 ft)		6.0 m (20 ft)		7.5 m (25 ft)		Capacity		Reach	
														m (ft)	
7.5 m (25 ft)	kg lb												*3810	2180	7.34 (24.1)
6.0 m (20 ft)	kg lb							*4150 *9150	3110 6860				*8400 7300	4810 3590	8.31 (27.3)
4.5 m (15 ft)	kg lb					*5500 *12130	4770 10520	*4710 *10380	2930 6460	3840 8470	1900 4190		2890 6370	1350 2980	8.87 (29.1)
3.0 m (10 ft)	kg lb					*7330 *16160	4220 9300	5400 11900	2690 5930	3730 8220	1800 3970		2700 5950	1220 2690	9.10 (29.9)
1.5 m (5 ft)	kg lb					8100 17860	3780 8330	5140 11330	2470 5450	3600 7940	1690 3730		2680 5910	1200 2650	9.05 (29.7)
Ground Line	kg lb			*9840 *21690	6700 14770	7850 17310	3570 7870	4970 10960	2320 5110	3520 7760	1610 3550		2840 6260	1280 2820	8.70 (28.5)
-1.5 m (-5 ft)	kg lb	*10680 *23550	*10680 *23550	*14730 *32470	6770 14930	7800 17200	3530 7780	4920 10850	2270 5000				3270 7210	1520 3350	8.00 (26.2)
-3.0 m (-10 ft)	kg lb	*15190 *33490	*15190 *33490	*13270 *29260	6960 15340	7900 17420	3620 7980	4990 11000	2330 5140				4290 9460	2080 4590	6.84 (22.4)
-4.5 m (-15 ft)	kg lb			*10270 *22640	7350 16200	*7070 *15590	3880 8550								

- Lifting capacity is based on SAE J1097, ISO 10567.
- Lifting capacity of the Robex Series does not exceed 75% of the tipping load with the machine on firm, level ground or 87% of full hydraulic capacity.
- The load point is a hook located on the back of the bucket.
- (*) indicates the load limited by hydraulic capacity.

Lifting Capacities

R210W-9A

Rating over-front Rating over-side or 360 degrees

Boom : 5.65 m (18' 6") / Arm : 2.92 m (9' 7") / Bucket : 0.80 m³ (1.05 yd³) SAE heaped / Front and rear outriggers down

Load point height m (ft)	Load radius										At max. reach			
	1.5 m (5 ft)		3.0 m (10 ft)		4.5 m (15 ft)		6.0 m (20 ft)		7.5 m (25 ft)		Capacity		Reach	
													m (ft)	
9.0 m (30 ft)	kg											*3410	*3410	6.52
	lb											*7520	*7520	(21.4)
7.5 m (25 ft)	kg											*3470	*3470	7.96
	lb											*7650	*7650	(26.1)
6.0 m (20 ft)	kg								*2690	*2690	*3580	3140	8.85	
	lb								*5930	*5930	*7890	6920	(29.0)	
4.5 m (15 ft)	kg						*4210	*4210	*3980	*3980	*3720	2770	9.37	
	lb						*9280	*9280	*8770	*8770	*8200	6110	(30.7)	
3.0 m (10 ft)	kg			*10720	*10720	*6550	*6550	*5090	*5090	*4410	3970	*3890	2600	9.59
	lb			*23630	*23630	*14440	*14440	*11220	11220	*9720	8750	*8580	5730	(31.5)
1.5 m (5 ft)	kg			*8900	*8900	*8350	*8350	*6020	5510	*4900	3820	*4080	2570	9.54
	lb			*19620	*19620	*18410	*18410	*13270	12150	*10800	8420	*8990	5670	(31.3)
Ground Line	kg			*10210	*10210	*9470	8490	*6730	5290	*5300	3710	*4290	2710	9.21
	lb			*22510	*22510	*20880	18720	*14840	11660	*11680	8180	*9460	5970	(30.2)
-1.5 m (-5 ft)	kg	*9470	*9470	*13480	*13480	*9820	8360	*7060	5190	*5440	3660	*4500	3060	8.56
	lb	*20880	*20880	*29720	*29720	*21650	18430	*15560	11440	*11990	8070	*9920	6750	(28.1)
-3.0 m (-10 ft)	kg	*12940	*12940	*14070	*14070	*9430	8410	*6830	5220			*4640	3860	7.50
	lb	*28530	*28530	*31020	*31020	*20790	18540	*15060	11510			*10230	8510	(24.6)
-4.5 m (-15 ft)	kg			*11670	*11670	*7990	*7990							
	lb			*25730	*25730	*17610	*17610							

Boom : 5.65 m (18' 6") / Arm : 2.92 m (9' 7") / Bucket : 0.80 m³ (1.05 yd³) SAE heaped / Front and rear outriggers up

Load point height m (ft)	Load radius										At max. reach			
	1.5 m (5 ft)		3.0 m (10 ft)		4.5 m (15 ft)		6.0 m (20 ft)		7.5 m (25 ft)		Capacity		Reach	
													m (ft)	
9.0 m (30 ft)	kg											*3410	2840	6.52
	lb											*7520	6260	(21.4)
7.5 m (25 ft)	kg											*3470	1870	7.96
	lb											*7650	4120	(26.1)
6.0 m (20 ft)	kg								*2690	2010	2970	1420	8.85	
	lb								*5930	4430	6550	3130	(29.0)	
4.5 m (15 ft)	kg						*4210	2990	3880	1930	2610	1190	9.37	
	lb						*9280	6590	8550	4250	5750	2620	(30.7)	
3.0 m (10 ft)	kg			*10720	7970	*6550	4340	*5090	2730	3740	1810	2450	1070	9.59
	lb			*23630	17570	*14440	9570	*11220	6020	8250	3990	5400	2360	(31.5)
1.5 m (5 ft)	kg			*8900	6830	8180	3840	5160	2470	3590	1670	2420	1040	9.54
	lb			*19620	15060	18030	8470	11380	5450	7910	3680	5340	2290	(31.3)
Ground Line	kg			*10210	6570	7830	3550	4950	2290	3480	1570	2550	1100	9.21
	lb			*22510	14480	17260	7830	10910	5050	7670	3460	5620	2430	(30.2)
-1.5 m (-5 ft)	kg	*9470	*9470	*13480	6590	7710	3450	4850	2200	3440	1530	2880	1290	8.56
	lb	*20880	*20880	*29720	14530	17000	7610	10690	4850	7580	3370	6350	2840	(28.1)
-3.0 m (-10 ft)	kg	*12940	*12940	*14070	6740	7760	3790	4870	2220			3630	1700	7.50
	lb	*28530	*28530	*31020	14860	17110	7690	10740	4890			8000	3750	(24.6)
-4.5 m (-15 ft)	kg			*11670	7050	7980	3670							
	lb			*25730	15540	17590	8090							

- Lifting capacity is based on SAE J1097, ISO 10567.
- Lifting capacity of the Robex Series does not exceed 75% of the tipping load with the machine on firm, level ground or 87% of full hydraulic capacity.
- The load point is a hook located on the back of the bucket.
- (*) indicates the load limited by hydraulic capacity.

Lifting Capacities

R210W-9A

Rating over-front Rating over-side or 360 degrees

Boom : 5.65 m (18' 6") / Arm : 2.92 m (9' 7") / Bucket : 0.80 m³ (1.05 yd³) SAE heaped / Front outrigger and rear dozer blade down

Load point height m (ft)	Load radius										At max. reach			
	1.5 m (5 ft)		3.0 m (10 ft)		4.5 m (15 ft)		6.0 m (20 ft)		7.5 m (25 ft)		Capacity		Reach	
													m (ft)	
9.0 m (30 ft)	kg											*3410	*3410	6.52
	lb											*7520	*7520	(21.4)
7.5 m (25 ft)	kg											*3470	3210	7.96
	lb											*7650	7080	(26.1)
6.0 m (20 ft)	kg								*2690	*2690		*3580	2580	8.85
	lb								*5930	*5930		*7890	5690	(29.0)
4.5 m (15 ft)	kg						*4210	*4210	*3980	3380		*3720	2250	9.37
	lb						*9280	*9280	*8770	7450		*8200	4960	(30.7)
3.0 m (10 ft)	kg		*10720	*10720	*6550	*6550	*5090	4750	*4410	3250		*3890	2090	9.59
	lb		*23630	*23630	*14440	*14440	*11220	10470	*9720	7170		*8580	4610	(31.5)
1.5 m (5 ft)	kg		*8900	*8900	*8350	7040	*6020	4460	*4900	3100		*4080	2070	9.54
	lb		*19620	*19620	*18410	15520	*13270	9830	*10800	6830		*8990	4560	(31.3)
Ground Line	kg		*10210	*10210	*9470	6700	*6730	4260	*5300	2990		*4290	2180	9.21
	lb		*22510	*22510	*20880	14770	*14840	9390	*11680	6590		*9460	4810	(30.2)
-1.5 m (-5 ft)	kg	*9470	*9470	*13480	*13480	*9820	6590	*7060	4160	*5440	2950	*4500	2470	8.56
	lb	*20880	*20880	*29720	*29720	*21650	14530	*15560	9170	*11990	6500	*9920	5450	(28.1)
-3.0 m (-10 ft)	kg	*12940	*12940	*14070	14020	*9430	6640	*6830	4190			*4640	3130	7.50
	lb	*28530	*28530	*31020	30910	*20790	14640	*15060	9240			*10230	6900	(24.6)
-4.5 m (-15 ft)	kg			*11670	*11670	*7990	6850							
	lb			*25730	*25730	*17610	15100							

Boom : 5.65 m (18' 6") / Arm : 2.92 m (9' 7") / Bucket : 0.80 m³ (1.05 yd³) SAE heaped / Front outrigger and rear dozer blade up

Load point height m (ft)	Load radius										At max. reach			
	1.5 m (5 ft)		3.0 m (10 ft)		4.5 m (15 ft)		6.0 m (20 ft)		7.5 m (25 ft)		Capacity		Reach	
													m (ft)	
9.0 m (30 ft)	kg											*3410	2840	6.52
	lb											*7520	6260	(21.4)
7.5 m (25 ft)	kg											*3470	1870	7.96
	lb											*7650	4120	(26.1)
6.0 m (20 ft)	kg								*2690	2010		2970	1420	8.85
	lb								*5930	4430		6550	3130	(29.0)
4.5 m (15 ft)	kg						*4210	2990	3880	1930		2610	1190	9.37
	lb						*9280	6590	8550	4250		5750	2620	(30.7)
3.0 m (10 ft)	kg		*10720	7970	*6550	4340	*5090	2730	3740	1810		2450	1070	9.59
	lb		*23630	17570	*14440	9570	*11220	6020	8250	3990		5400	2360	(31.5)
1.5 m (5 ft)	kg		*8900	6830	8180	3840	5160	2470	3590	1670		2420	1040	9.54
	lb		*19620	15060	18030	8470	11380	5450	7910	3680		5340	2290	(31.3)
Ground Line	kg		*10210	6570	7830	3550	4950	2290	3480	1570		2550	1100	9.21
	lb		*22510	14480	17260	7830	10910	5050	7670	3460		5620	2430	(30.2)
-1.5 m (-5 ft)	kg	*9470	*9470	*13480	6590	7710	3450	4850	2200	3440	1530	2880	1290	8.56
	lb	*20880	*20880	*29720	14530	17000	7610	10690	4850	7580	3370	6350	2840	(28.1)
-3.0 m (-10 ft)	kg	*12940	*12940	*14070	6740	7760	3490	4870	2220			3630	1700	7.50
	lb	*28530	*28530	*31020	14860	17110	7690	10740	4890			8000	3750	(24.6)
-4.5 m (-15 ft)	kg			*11670	7050	7980	3670							
	lb			*25730	15540	17590	8090							

- Lifting capacity is based on SAE J1097, ISO 10567.
- Lifting capacity of the Robex Series does not exceed 75% of the tipping load with the machine on firm, level ground or 87% of full hydraulic capacity.
- The load point is a hook located on the back of the bucket.
- (*) indicates the load limited by hydraulic capacity.

STANDARD EQUIPMENT R210W-9A

ISO Standard cabin

All-weather steel cab with 360° visibility
Safety glass windows
Rise-up type windshield wiper
Sliding fold-in front window
Sliding side window (LH)
One key fits all lockable doors
Hot & cool box
Storage compartment & Ashtray
Radio / MP3 Player with remote control and USB-input
Handsfree mobile phone system with USB-charging device
Transparent cabin roof-cover
12 volt power outlet (24V DC to 12V DC converter)
Sun visor
Rain guard - front window
Computer aided power optimization (CAPO) system
3-power modes, 2-work modes, User mode
Auto & one-touch deceleration system
Auto warm-up system
Overheat prevention system
Automatic temperature control
Air conditioner & heater
Defroster
Self-diagnostics system
Starting Aid (air grid heater) for cold weather
Centralized monitoring
LCD display
Engine speed or Trip meter
Clock
Gauges
- Fuel level gauge
- Engine coolant temperature gauge
- Hyd. oil temperature gauge
Warning lamps
- Engine warning
- Overload
- Communication error
- Low battery
- Air filter clogging
Indicators
- Max power
- Low speed/High speed
- Fuel warmer
- Auto deceleration
Rearview camera
Two outside rearview mirrors
Mechanical suspension seat with heater with seat belt
Adjustable joysticks
Console box tilting system
Two front working lights
Electric horn
Batteries (2 x 12V x 100 Ah)
Battery master switch
Removable clean-out screen for coolers
Automatic swing brake
Removable reservoir tank
Fuel pre-filter with fuel warmer
Boom holding system
Arm holding system
Accumulator for lowering work equipment
Electric transducer
Lower frame under cover
Viscous fan clutch
Dual tires (10.00-20-16PR)
Fuel filler pump (50 ℓ/min)
Safety lock valve for boom cylinder with overload warning device

Double-acting piping kit (clamshell, etc.)
Travel alarm
Boom
5.65 m; 18' 6"
Arm
2.9 m; 9' 7"
Cabin ROPS (ISO 12117-2)
ROPS (Roll Over Protective Structure)
Hi-mate (Remote Management System)
Smart key + Start button
Travel pedal (1 way)

OPTIONAL EQUIPMENT R210W-9A

Beacon lamp
Safety lock valve for arm cylinder
Single-acting piping kit (breaker, etc.)
Boom
5.55 m; 2pc
Arms
2.0 m; 6' 7" Super short arm
2.4 m; 7' 10" Short arm
3.9 m; 12' 10" Long arm
Cabin FOPS/FOG (ISO/DIS 10262 Level II)
FOPS (Falling Object Protective Structure)
FOG (Falling Object Guard)
Cabin roof-steel cover
Cabin guard-front
Wire net
Cabin lights
Undercarriage
Front and rear blade
Front and rear outrigger (Independent)
Front blade and rear outrigger
Tool kit
Seat
Adjustable air suspension seat
Adjustable air suspension seat with heater
Mechanical suspension seat
Dual tires - solid (10.00 - 20)
Fenders (Mudguards)
Travel pedal (2 way)
Rear work lamp
Quick coupler piping

- * Standard and optional equipment may vary. Contact your Hyundai dealer for more information. The machine may vary according to international standards.
- * The photos may include attachments and optional equipment that are not available in your area.
- * Materials and specifications are subject to change without advance notice.
- * All imperial measurements rounded off to the nearest pound or inch.

PLEASE CONTACT

